



Installation Instructions

911 GT3 Cup Charging Loom (Type 992)

MT000116A

Version_V1_2021/08

Contact

Manthey-Racing GmbH

Technical Support

Rudolf-Diesel-Str. 11-13
53520 Meuspath
Deutschland

Telephone: +49 (0) 2691 9338 807

E-Mail: techsupport@manthey-racing.de

Note

By constantly optimizing our products, there are regular updates to this document. Please note that only the current version of the document is valid. In the download area the current documents are available for download. This vehicle is specially designed for participation in competitions on circuits.

Manthey-Racing GmbH assumes no responsibility for the compliance of the regulations. Illustrations, descriptions and schematics serve exclusively to represent the text. We assume no liability for the completeness and conformity of the content with the respective valid sporting regulations.

The technical documentation for the 911 GT3 Cup (Type 992) of Porsche AG must be observed.



Download Area

The installation and operating instructions as well as the technical manuals are available for downloading under the following link.

<http://www.manthey-racing.de/downloads.htm>

Warning and safety instructions

The classification of the warning and safety information is made using the respective signal word (Danger, Warning, Caution) in addition to the warning icon.

 DANGER	Warning of death or serious bodily injuries, which will occur in the event of non-compliance.
 WARNING	Warning of death or serious bodily injuries, which may occur in the event of non-compliance.
 ATTENTION	Warning of minor bodily injuries in the event of non-compliance.
NOTE	Warning of property damage in the event of non-compliance.

1.1 General Warning and Safety Instructions

⚠ DANGER

Risk of Injury and accident during and after work on the vehicle:

- Repairs are to only be carried out if access to technical documentation for the vehicle is available in the Porsche Motorsport Racing Vehicle Service Information portal (PMRSI).
- Follow the safety instructions.

⚠ DANGER

Falling vehicle risk:

Risk of Squashing or Crushing.

Damage to vehicle.

- Do not place any rigid objects under the lifted vehicle.
- Secure lifting platform against lowering.
- Remove all objects under vehicle before lowering.
- Raise the vehicle using only the designated vehicle lifting points.
- Outer-most vehicle lifting points should be used as a matter of priority.

⚠ WARNING

Improper handling of safety-related fasteners risk:

Risk of Injury.

Loosening of fasteners.

Torque Drop.

- Always use new fastening screws and nuts after every disassembly.
- Observe the specified tightening torques.
- Visually inspect the components used.

⚠ WARNING

Heavy Components:

Risk of Crushing.

- Wear Personal Protective Equipment (PPE).
- If necessary seek assistance during task.

⚠ WARNING

Flying foreign object during grinding, drilling and milling:

Risk of eye injuries.

- Wear safety glasses.

1.1 General Warning and Safety Instructions

WARNING

Falling objects or loads:

Risk of Squeezing or crushing.

- Secure components against falling.

WARNING

Non heat-resistant materials:

Fire Hazard.

- Avoid contact with hot components or sources of ignition.

ATTENTION

Sharp or sharp-edged objects:

Risk of Cracks, Punctures, or Cuts.

- Wear Personal Protective Equipment (PPE).

ATTENTION

Hot components:

Risk of Burns.

- Allow hot components to cool down.
- Wear Personal Protective Equipment (PPE).

ATTENTION

Heavy Components:

Risk of Crushing

- Wear Personal Protective Equipment (PPE).
- If necessary seek assistance during task.

NOTE

Always observe the currently valid "Technical Information" (TI) from Porsche AG. These can be viewed and downloaded at <https://motorsport.porsche.de>.

2.1 Component Overview - Battery Charging Loom

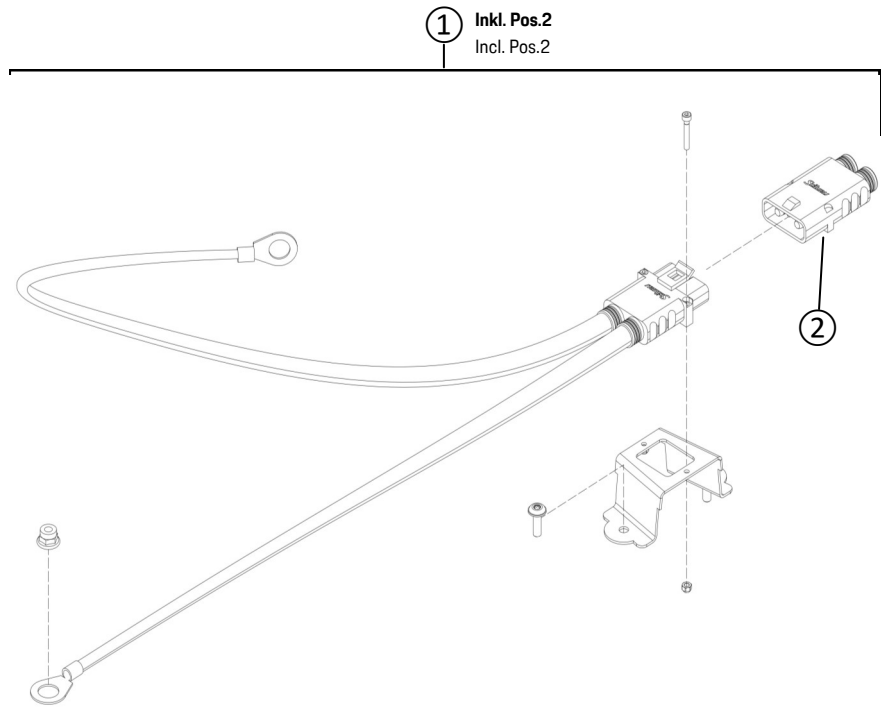

Pos.	Bezeichnung / Description	M	A.	Teile Nr. / Part no.
1	Z LADEKABEL BATTERIE 992 GT3 CUP AS BATTERY CHARGING LOOM 992 GT3 CUP		2	MT000116A
2	LADERSTECKER EXTERN – CEB22-1616 EXTERNAL CHARGING CONNECTOR – CEB22-1616		2	MR019610

2.2 Battery Charging Loom Installation

Step 1:

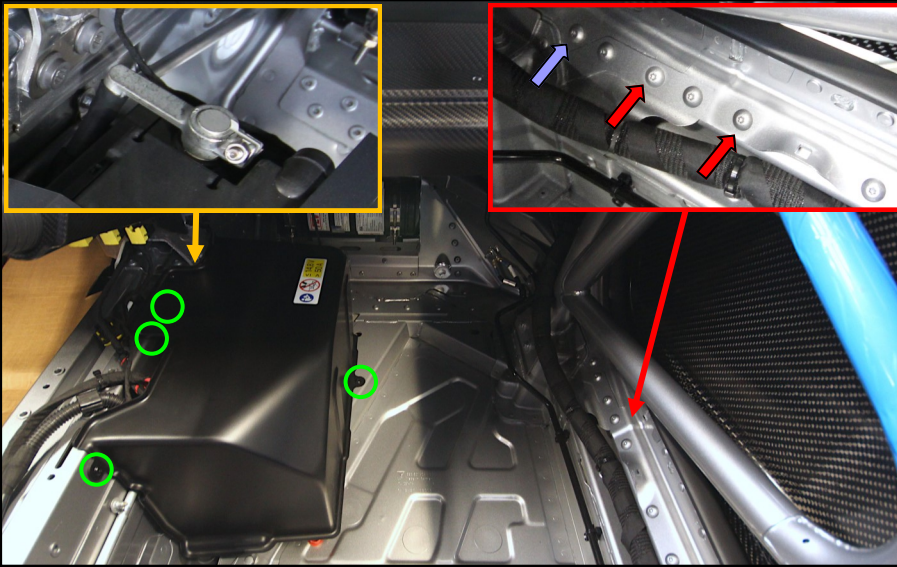

Step 2:

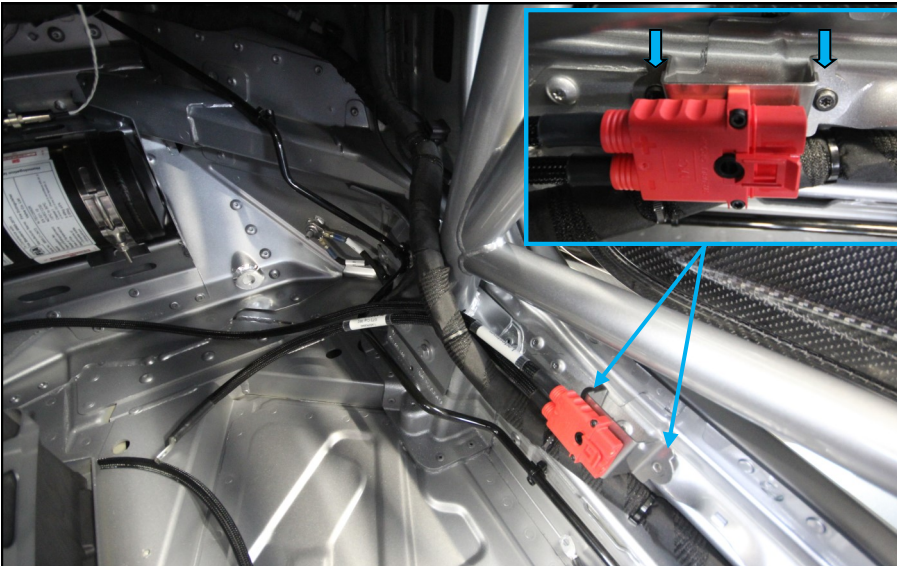

Step 3:

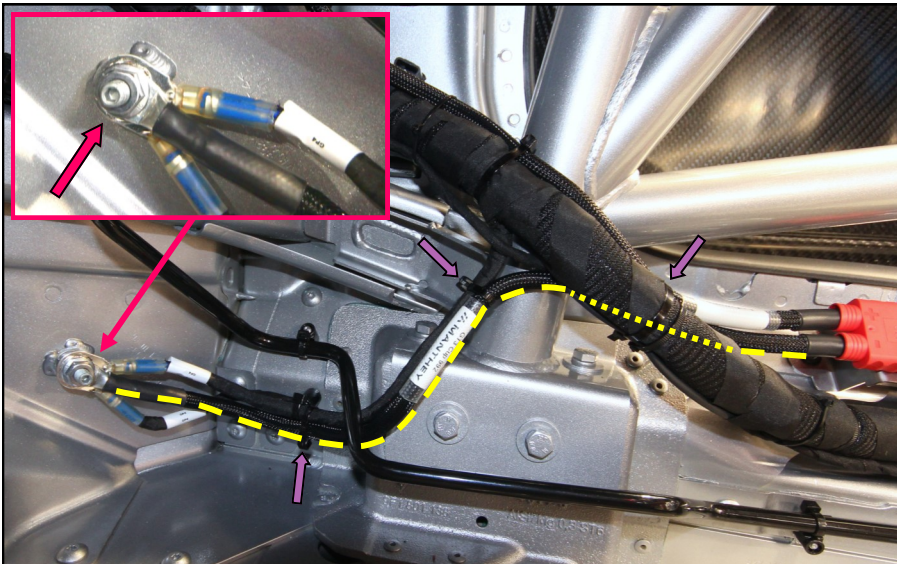

Step 1:

Remove the four indicated M5 button head T25 torx screws securing the battery cover. Remove the battery cover.

Loosen and remove the battery ground terminal (-) from the battery. Position securely away from the battery for the duration of the installation.

Remove the two indicated M5 button head T25 torx screws from the inner sill on the passenger side of the vehicle (Third and fifth screw counted from the leftmost screw).

Step 2:

Position the charging connector bracket the passenger side inner sill so the holes in the mounting bracket align with the available threaded holes.

Secure the bracket to the inner sill using the included M5x16 Flanged T25 Torx Screws.



M5x16 Flange Screws
Tightening Torque: 4.5 Nm

NOTE

The charging connector should be directed toward the rear of the vehicle

Step 3:

Route the earthing cable (Short) along the path shown to the grounding point in the passenger foot well.

Remove the M8 flange nut from the grounding stud. Mount the eye terminal of the earth cable onto the grounding stud.

Refit and tighten the M8 flange nut.



M8 Flange Nut
Tightening Torque: 9.7 Nm

Secure the earth cable with cable ties at regular intervals.

NOTE

Ensure the cable is free of tension and abrasion points.

911 GT3 Cup (Type 992)
Charging Loom Installation

2.2 Battery Charging Loom Installation

Step 4:

Step 4:

Route the charging cable (Long) along the vehicle body harness on the path shown underneath the dashboard towards the centre console.

Secure the charging cable to main vehicle harness at regular intervals with cable ties.

Route the cable so that it exits beneath the centre console and neatly along the central tunnel towards the battery.

NOTE

Ensure the cable is free of tension and abrasion points.

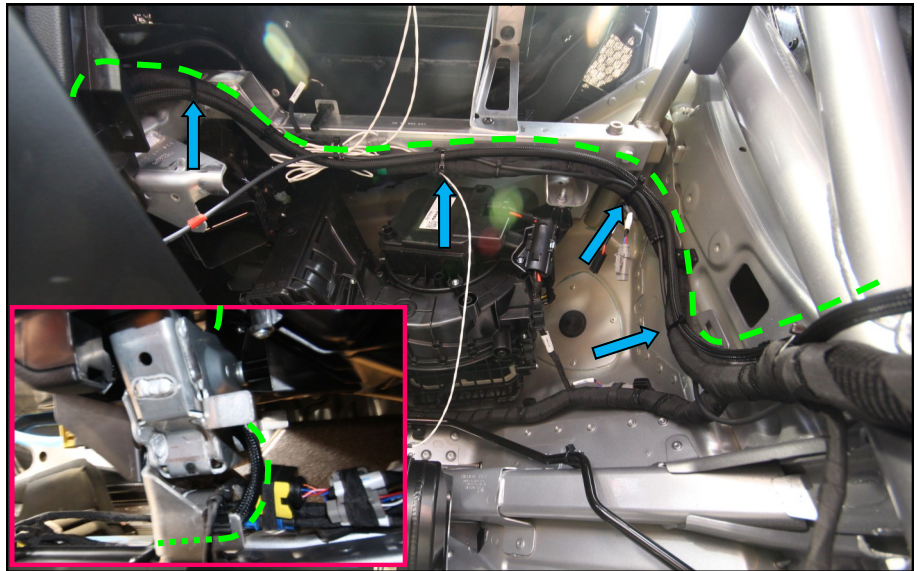

Step 5:

Step 5:

Place the eye terminal of the charging cable onto the threaded stud located on the positive (+) battery terminal.

Secure the terminal to the stud with the included M6 locknut.



M6 Flanged Locknut

Tightening Torque: 8 Nm

Reinstall the ground terminal onto the battery and tighten.



Ground Terminal Clamping Nut

Tightening Torque: 5 Nm

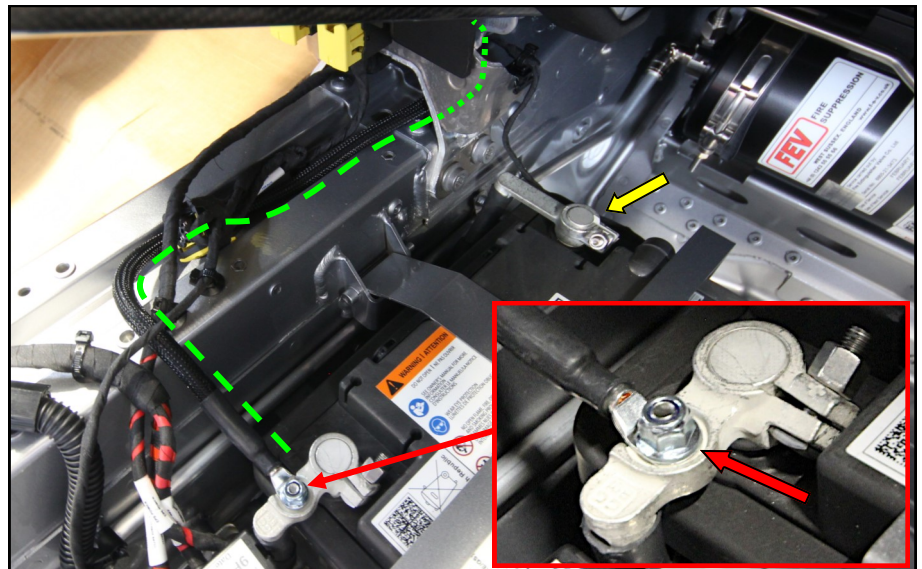

Step 6:

Re-install the battery cover and secure using the four original M5x16 flange screws.



M5x16 Flange Screws

Tightening Torque: 4.5 Nm

For the correct connection of the external 2-pin connection plug included in the scope of delivery to a charger or similar, the manufacturers (Stäubli) installation instructions for this type of plug must be adhered to. Installation instructions are included with the connector.

911 GT3 Cup (Type 992) Charging Loom Installation

Step 6:



