

MANTHEY - RACING



Installation manual

window net V2

MTH801010

Version _V3_2017/12

Contact

Manthey-Racing GmbH

Technical Support

Rudolf-Diesel-Str. 11-13

53520 Meuspath

Germany

Phone: +49 (0) 2691 9338 807

E-Mail: techsupport@manthey-racing.de

Note

Due to the ongoing optimization of our products, this document will be updated on a regular basis. Please note that only the current version of this document is valid. The current documents are available in the download area.

Download area:

The installation and operating instructions as well as the technical manuals are available for download under the following link.

<http://www.manthey-racing.de/downloads.htm>

Warning and safety instructions

The classification of the warning and safety information is made using the respective signal word (Danger, Warning, Caution) in addition to the warning icon.



Warning of death or serious bodily injuries, which will occur in the event of non-compliance.



Warning of death or serious bodily injuries, which may occur in the event of non-compliance.



Warning of minor bodily injuries in the event of non-compliance.



Warning of property damage in the event of non-compliance.

General safety instructions

DANGER

Risk of injury and risk of accident during and after work on the vehicle

- Repairs are to be carried out only if access to the repair handbooks in the PIWIS Information System is also available
- Observe the safety instructions
- Observe the repair handbooks of the vehicle series in the PIWIS Information System.

DANGER

Crashing vehicle

Squeezing or crushing

Damage to the vehicle

- Do not place any rigid objects under the lifted vehicle.
- Secure lifting platform against lowering.
- Remove any rigid objects before lowering.
- Lift the vehicle only at the pick-up points designated for this purpose.
- The outer pick-up points should be used as a matter of priority.

WARNING

Improper handling of safety-relevant fitting

Injuries

Torque reduction

- Use new fastening screws and nuts after every dismantling
- Observe the specified tightening torques.
- Visually inspect the parts used

NOTE

Always observe the currently valid „Technical Information“ (TI) of Porsche AG. These can be viewed and downloaded at motorsport.porsche.de.

If you do not have access to this portal, please contact gt4clubsport@porsche.de.

Always use this manual in accordance with the currently valid Technical Information (TI) of the Porsche AG.

⚠ WARNING

Working with compressed air

Eye injuries

Damage and contamination of components

- Wear safety goggles with side shield.
- Secure the compressed air discharge point with suitable materials.
- Place the compressed air discharge point on suitable areas.

⚠ WARNING

Toxic exhaust fumes

Suffocation

- When the engine is running, position the exhaust gas extraction system behind the exhaust end pipes of the vehicle and switch it on.

⚠ WARNING

Falling objects or loads

Squeezing or crushing

- Secure components against falling.

⚠ WARNING

Flying foreign bodies during grinding, drilling and milling

Eye injuries

- Wear safety goggles.

⚠ WARNING

No heat-resistant materials

Fire

- Avoid contact with hot components or sources of ignition.

⚠ ATTENTION

Sharp or sharp-edged objects

Cracks, punctures, cuts

- Wear personal protective equipment.

⚠ ATTENTION

Hot components

Burns

- Allow hot components to cool down.
- Wear personal protective equipment.

⚠ ATTENTION

Heavy components

Crushing

- Wear personal protective equipment.
- If necessary call somebody to help you.

HINWEIS

The net ist not scope of delivery.

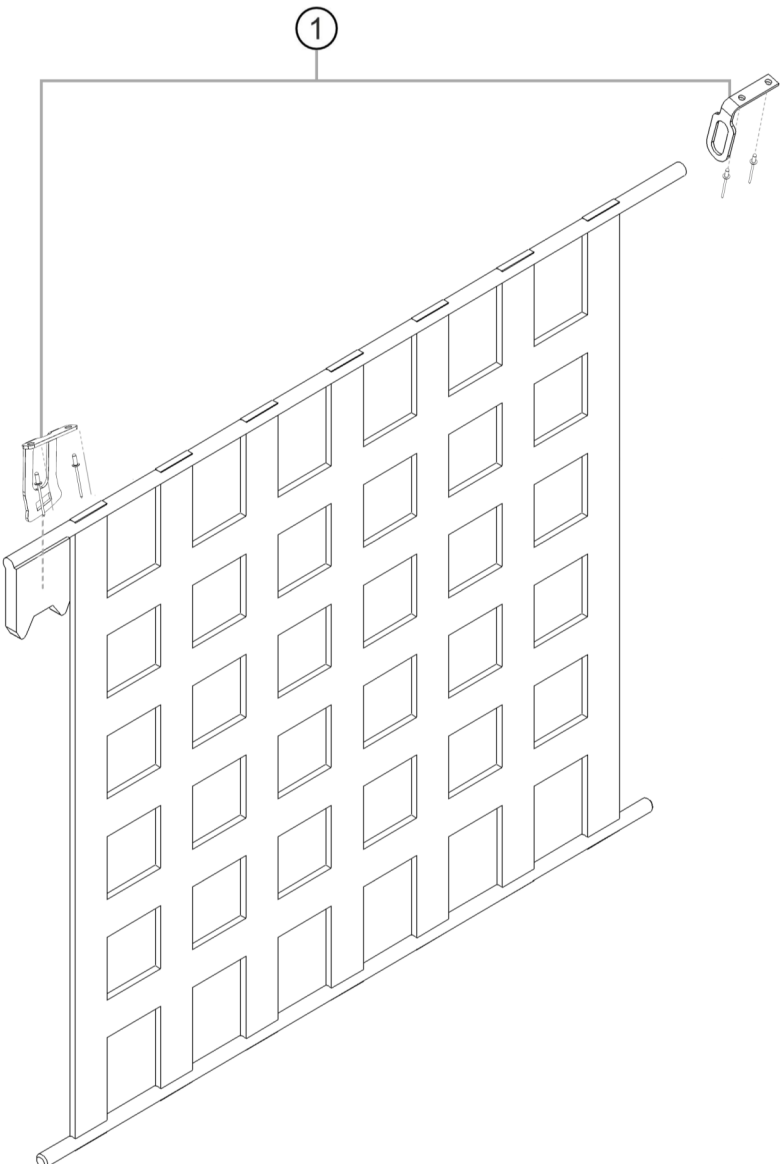

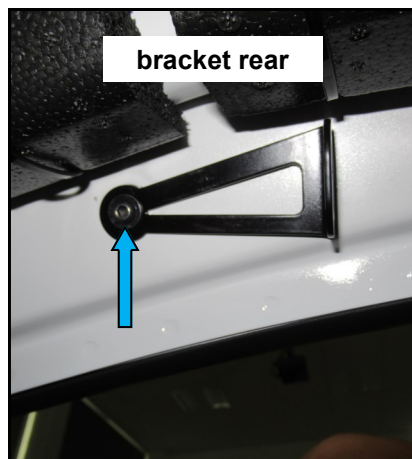
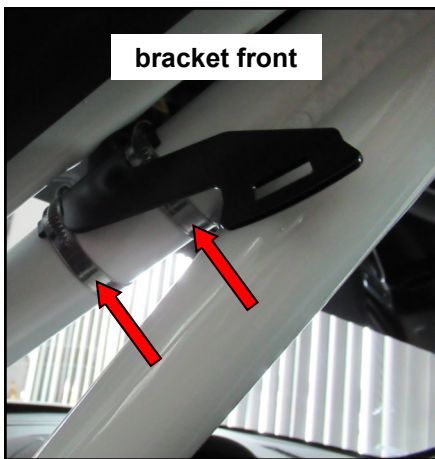

Pos.	Bezeichnung / Description	M	A.	Teile Nr. / Part no.
1	KIT-NETZHALTER V2 AS WINDOW NET V2		1	MTH801010

Step 1:



Step 1:

Remove the brackets of the existing window net. To do this, remove both  clamps from the front bracket. Then  loosen the screw of the rear bracket. These brackets are no longer required.

Step 2:

Place the new front bracket 65 mm away from the sheet metal overlap  on the roof rail. Mark the holes for the rivets. Drill the two holes with a 4.0 mm hard metal drill bit (HM). Attach the bracket with the supplied rivets (4x10 mm).

Place the rear bracket approx. 540mm from the front sheet metal overlap . The attachment is similar to the front bracket.

Step 2:

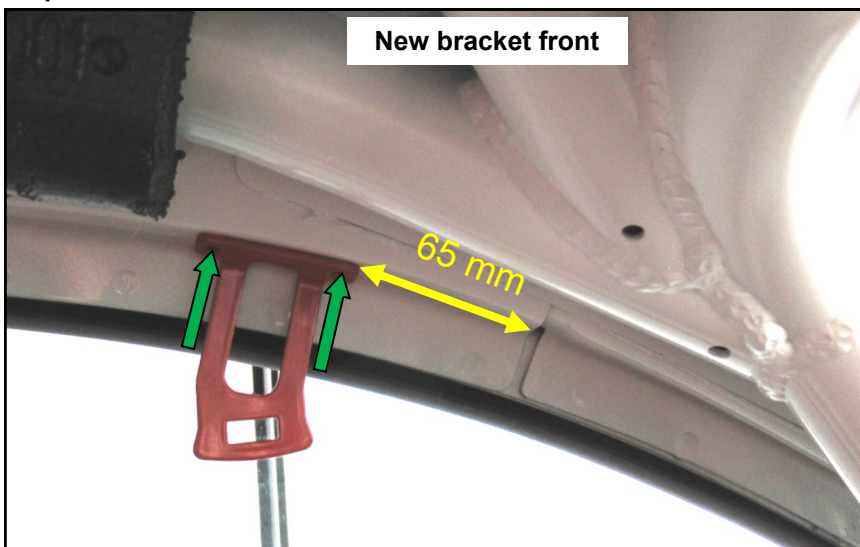

NOTE

The roof rail is made of high-strength steel. The use of a 4.0 mm hard metal drill bit is recommended for drilling.

NOTE

If the window net is installed, the upper bar in the rear holder **MUST** have an overlap of at least 30 mm.

⚠ WARNING

Danger of injury due to rotating cutting tools and roving chips! Wear personal protective equipment.

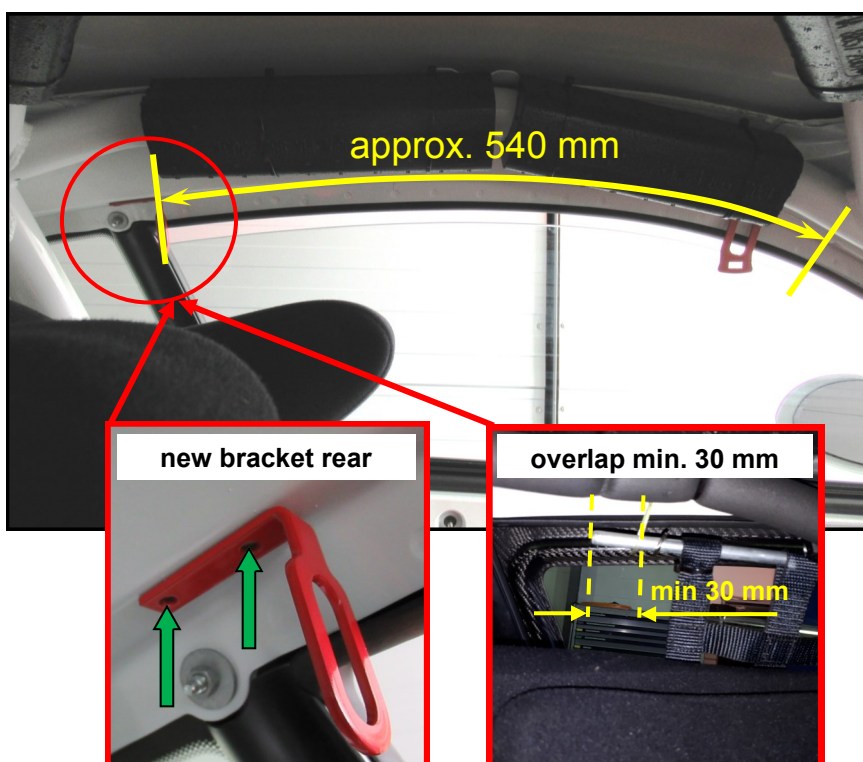

Step 3:

The position of the front net ribbon must be changed. Pass it through the rear opening roll cage intersection. ↓

NOTE

In order to achieve a better distinction between the door strap and the door opener strap, the red ribbon of the door strap can be replaced by a black ribbon or covered with black tape. ↓

Step 3:

